



INSTRUCTION GUIDE : BST SERIES WHEELS

NEEDED:

Stan's NoTubes ZTR wheel set, 2 tires, Stan's NoTubes Tire Sealant, core remover tool, injector or 2 oz. bottle, floor pump or compressor, soapy water, safety goggles.

WARNING:

Always wear safety goggles, Sealant can stain clothes or furniture.

IMPORTANT NOTE:

Never inflate any tire without a tube above 40psi unless it is specifically labeled for tubeless use. Maximum pressure listed on your rims may differ from maximum pressure listed on your tires. Do not inflate above the lower of the two numbers.

1

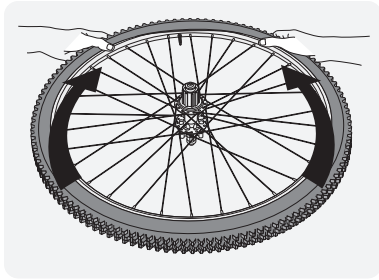

Mount tire: Making sure to position the tire bead in the center channel of the rim, mount one tire bead beginning opposite the valve and finishing at the valve. Once the first bead is mounted begin mounting the second bead opposite the valve and finish at the valve.

2

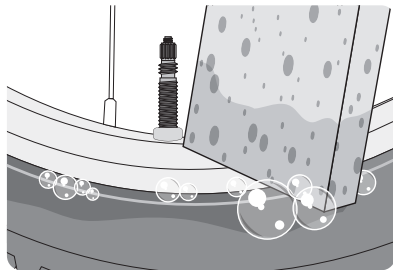

With a brush or sponge apply a generous amount of soapy water to both beads of the tire to help it slip onto the bead of the rim when inflating.

3

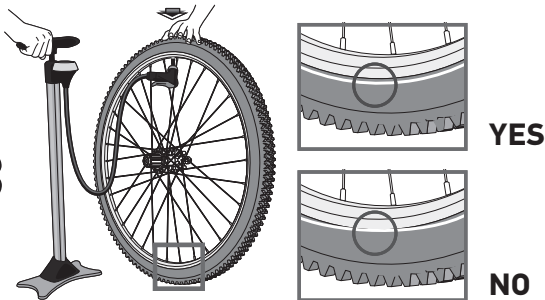

Rotate the valve to 12 o'clock and install a pump. Inflate tire to 35psi to seat tire.

4

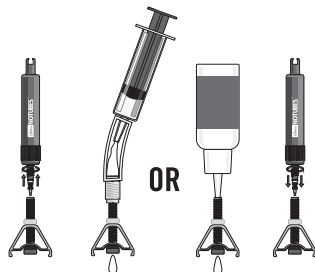

Add sealant: Once successful with inflation remove the valve core to add Stan's sealant. Add 2-4 oz. of sealant.

5

RECOMMENDED TIRE PRESSURE

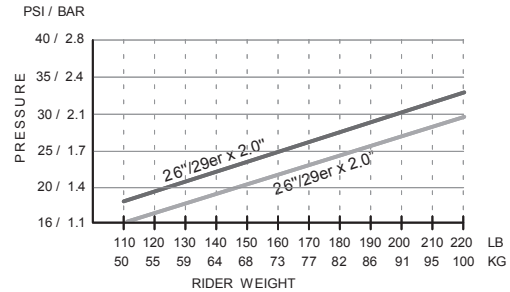

Inflate to riding pressure; the chart above is a recommended starting point. Always review the maximum pressure information listed on both the rim and the tire and consider the lower of the two numbers your maximum pressure. Do not inflate above the lower of the two numbers.

6

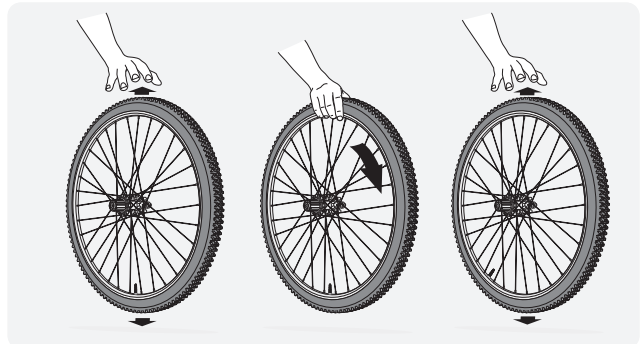

Bounce: hold the wheel vertically and gently bounce or "dribble" it to disperse the sealant throughout the inside of the tire. Let it drop from an inch or two, then rotate a few degrees and repeat. Do this for several revolutions of the wheel.

7

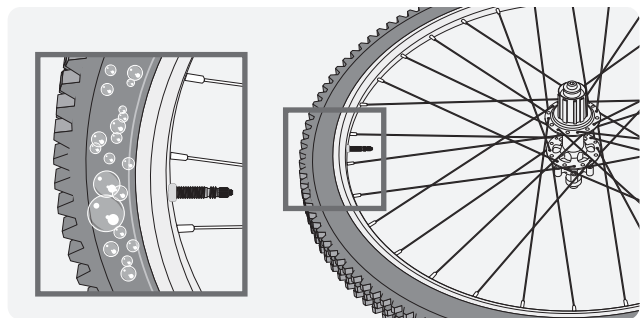

Lay tire on side and apply a thin sheen of soapy water around the sidewall and the bead area. Look for suds occurring anywhere on the tire or bead area. Suds bubbling out from the tire indicate porous areas. Shake the sealant to those areas to seal them and apply soap and water again. Check for suds forming on both sides of the tire. Repeat until no suds remain. Install the cassette and rotors according to the component manufacturer's recommendations.

STAN'S NOTUBES ZTR RIM SETUP GUIDE: BST SERIES WHEELS



RIMS	WEIGHT 26/27.5/29	ERD	SPOKE TENSIONS (KGF)	Yellow Tape and Valve Compatibility				PV 35mm	SV 32mm
				TAPE 21mm	25mm	27mm	30mm		
Valor	278/301/325g	541/564/602	105		X			X	
Bravo	432/450/475g	537/563/600	105			X		X	
Crest MK3	326/341/364g	542/567/605	95		X			X	
Arch MK3	406/425/453g	542/567/605	125			X		X	
Flow MK3	459/480/527g	542/567/605	125				X	X	
Iron Cross	385g	600	125	X					
Crest	340/355/380g	541/565/605	95	X	X			X	
Arch EX	420/440/470g	541/565/605	125		X			X	
Flow EX	490/510/545g	537/562/601	125		X	X		X	
Hugo	690/720/780g	552/577/614	105			X			X



VALOR



BRAVO



CREST MK3

* All rims are designed for disc brake use only



ARCH MK3

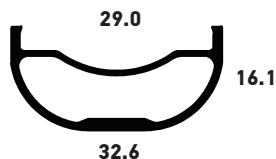

FLOW MK3



IRON CROSS



HUGO

RIMS:

Valor
Bravo
Crest MK3
Arch MK3
Flow MK3
Crest
Arch EX
Flow EX
Hugo
Iron Cross

ZTR Rims are optimized for tubeless use and are designed to set up tubeless with Stan's Yellow Tape, Universal Tubeless Valves, and Tire Sealant. Tubes may be used on all ZTR rims, though, as with all tube installations, extra care should be taken when mounting the tire, as improperly installed tubes can get caught underneath the bead of the tire and cause the tire to dismount when inflated.

Spokes and Spoke Nipples:

The rim does not use eyelets and therefore spoke nipples must be lubricated to aid in the wheelbuilding/truing process. NoTubes recommends synthetic 0 weight oil but any light oil will work.

Rim Tape:

Stan's NoTubes Yellow Rim Tape is designed for use with ZTR rims and the use of other tapes is not recommended. BST rims require one layer of Yellow Tape (see above chart for width).

Tubeless Setup:

Important: Never inflate any tire without a tube above 40psi unless it is specifically labeled for tubeless use. Maximum pressure listed on your rims may differ from maximum pressure listed on your tires. Do not inflate above the lower of the two numbers.

Spoke Tension:

Check the chart above for correct tensions. Do not over tension the spokes. If spokes are over-tensioned the wheel will not stay true.

Watch our how-to video at: <http://www.notubes.com/help/>

NOTUBES.COM • 202 Daniel Zenker Dr., Big Flats, NY14814 • (607) 562-2877 • sales@notubes.com

EIS-011 R2 ZTR Rim and Wheelset Instructions: BST Series